



(12) **United States Patent**
Crispin

(10) **Patent No.:** **US 10,060,702 B2**
(45) **Date of Patent:** ***Aug. 28, 2018**

(54) **DUAL FIELD OPTICAL AIMING SYSTEM FOR PROJECTILE WEAPONS**

(71) Applicant: **Leupold & Stevens, Inc.**, Beaverton, OR (US)

(72) Inventor: **Quint Crispin**, Beaverton, OR (US)

(73) Assignee: **Leupold & Stevens, Inc.**, Beaverton, OR (US)

(*) Notice: Subject to any disclaimer, the term of this patent is extended or adjusted under 35 U.S.C. 154(b) by 0 days.

This patent is subject to a terminal disclaimer.

(21) Appl. No.: **15/441,126**

(22) Filed: **Feb. 23, 2017**

(65) **Prior Publication Data**

US 2017/0321993 A1 Nov. 9, 2017

Related U.S. Application Data

(63) Continuation-in-part of application No. 15/431,594, filed on Feb. 13, 2017, now abandoned, which is a (Continued)

(51) **Int. Cl.**
F41G 1/38 (2006.01)
F41G 1/387 (2006.01)
(Continued)

(52) **U.S. Cl.**
CPC **F41G 1/387** (2013.01); **F41G 1/30** (2013.01); **F41G 1/38** (2013.01); **G02B 23/14** (2013.01)

(58) **Field of Classification Search**
CPC ... F41G 1/387; F41G 1/30; F41G 1/38; G02B 23/14
See application file for complete search history.

(56) **References Cited**

U.S. PATENT DOCUMENTS

1,563,373 A 12/1925 Kauch
2,225,037 A * 12/1940 Dake F41G 1/38 356/254

(Continued)

FOREIGN PATENT DOCUMENTS

CA 670887 A 9/1963
EP 0234180 A1 9/1987

(Continued)

OTHER PUBLICATIONS

Wikipedia, Holographic Weapon Sight, en.wikipedia.org/wiki/Holographic_weapon_sight, published Jan. 28, 2013, 2 pages.

(Continued)

Primary Examiner — Samir Abdosh

(74) *Attorney, Agent, or Firm* — Stoel Rives LLP

(57) **ABSTRACT**

A system for aiming a projectile weapon includes a telescopic sight for use with a second sighting device, such as a reflex sight or other non-magnifying sight. The telescopic sight has an eye point spaced apart rearwardly from its eyepiece and positioned at a vertical plane containing a line of initial trajectory of the weapon to which the aiming system is mounted so that a line parallel to the line of initial trajectory does not intersect the eyepiece. The location of the eye point facilitates concurrent use of a second sighting device at a normal mounting height and viewable past the eyepiece, thereby allowing the viewer to change views between the telescopic sight and the second sighting device with little eye movement and essentially no head movement.

26 Claims, 12 Drawing Sheets

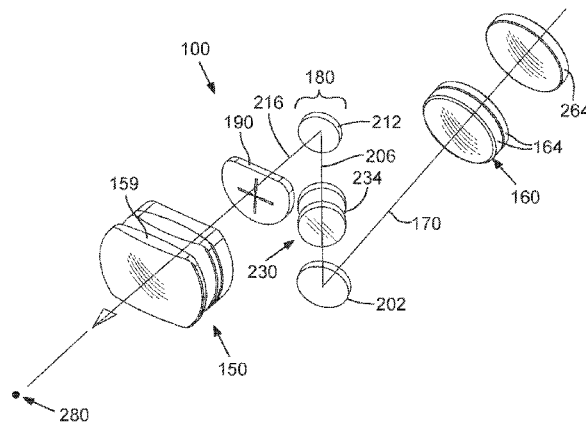

Related U.S. Application Data

continuation-in-part of application No. 14/834,272, filed on Aug. 24, 2015, now Pat. No. 9,568,277, which is a continuation of application No. 13/843,445, filed on Mar. 15, 2013, now Pat. No. 9,115,958.

(51) **Int. Cl.**

G02B 23/14 (2006.01)
F41G 1/30 (2006.01)

(56)

References Cited

U.S. PATENT DOCUMENTS

2,388,673	A	11/1945	Brown	
2,512,153	A	6/1950	Heney et al.	
2,527,719	A *	10/1950	Greenstein	G02B 15/00 359/420
3,339,450	A	9/1967	Reed	
3,655,260	A	4/1972	Bartucci	
3,992,782	A	11/1976	Rickert	
4,118,109	A	10/1978	Crawford	
4,545,655	A	10/1985	Fantone et al.	
4,582,400	A	4/1986	Lough	
4,877,318	A	10/1989	Miles	
5,084,780	A	1/1992	Phillips	
5,161,051	A	11/1992	Whitney et al.	
5,349,469	A	9/1994	Francis	
5,383,278	A	1/1995	Kay	
D369,363	S	5/1996	Palmer	
5,652,679	A *	7/1997	Freeman	G02B 17/0812 359/364
5,740,485	A *	4/1998	Miyamoto	G02B 23/14 396/384
5,862,001	A	1/1999	Sigler	
5,877,902	A	3/1999	Sauter	
D413,130	S	8/1999	Bryant et al.	
6,005,711	A	12/1999	Mai et al.	
6,282,021	B1	8/2001	Yano	
D449,899	S	10/2001	Hayakawa et al.	
6,327,806	B1	12/2001	Paige	
6,363,648	B1	4/2002	Kranich et al.	
6,487,809	B1	12/2002	Gaber	
6,598,333	B1	7/2003	Randazzo et al.	
6,608,298	B2	8/2003	Gaber	
6,687,053	B1	2/2004	Holmes et al.	
D490,921	S	6/2004	Ashfield et al.	
D522,031	S	5/2006	Siu	
7,072,107	B2	7/2006	Filipovich et al.	
7,142,357	B2	11/2006	Greenslade	
D580,961	S	11/2008	Cicccone, Jr. et al.	
7,522,336	B2	4/2009	Whitty	

D599,924	S	9/2009	Schoch	
7,752,798	B2 *	7/2010	Mayerle	F41G 1/41 42/118
7,827,723	B1	11/2010	Zaderey et al.	
8,056,245	B2	11/2011	Cranton et al.	
D669,930	S	10/2012	Koyama et al.	
D694,800	S	12/2013	Miyashita	
D712,001	S	8/2014	Wells	
D741,446	S	10/2015	Cheng et al.	
9,291,808	B2	3/2016	Feinberg	
D757,147	S	5/2016	Edwards et al.	
2004/0075894	A1	4/2004	Shafer et al.	
2005/0039370	A1	2/2005	Strong	
2009/0224154	A1	9/2009	Jancic et al.	
2011/0026012	A1	2/2011	Barth	
2011/0035980	A1	2/2011	Raviv et al.	
2011/0041377	A1	2/2011	Thomas et al.	
2011/0067288	A1	3/2011	Hakansson et al.	
2011/0199677	A1	8/2011	Shick et al.	
2011/0232152	A1	9/2011	Thomas et al.	
2012/0013528	A1	1/2012	Browe et al.	
2012/0192478	A1	2/2012	Jahromi	
2012/0268920	A1	10/2012	Matthews et al.	
2013/0008072	A1	1/2013	Chung	
2014/0190063	A1	7/2014	Lau	
2014/0259853	A1	9/2014	Crispin	
2014/0305022	A1	10/2014	Chung	
2016/0061568	A1	3/2016	Crispin	
2016/0116254	A1	4/2016	Jahromi	
2016/0356572	A1	12/2016	Jahromi	
2016/0356575	A1	12/2016	Jahromi	

FOREIGN PATENT DOCUMENTS

EP	2 557 450	A1	2/2013
WO	WO 2012/058453	A2	5/2012

OTHER PUBLICATIONS

L-3 Communications, EOTech Holographic Weapons Systems, HHS II, www.eotech-inc.com/products/sights/hhs2, visited Mar. 7, 2013, 2 pages.
European Search Report dated May 19, 2014 for European Application No. 14160137.7.
Reviews & Ratings for Bushnell 4.5x40 Equinox Z Digital Night Vision Monocular 10 reviews, posted at Optics Planet, comment posting date Jun. 25, 2014. [online], [site visited Oct. 14, 2016]. Available from Internet, <URL: <http://www.opticsplanet.com/reviews/reviews-bushnell-3x30-equinox-digital-night-vision-monocular-qcsdm.html>>.

* cited by examiner

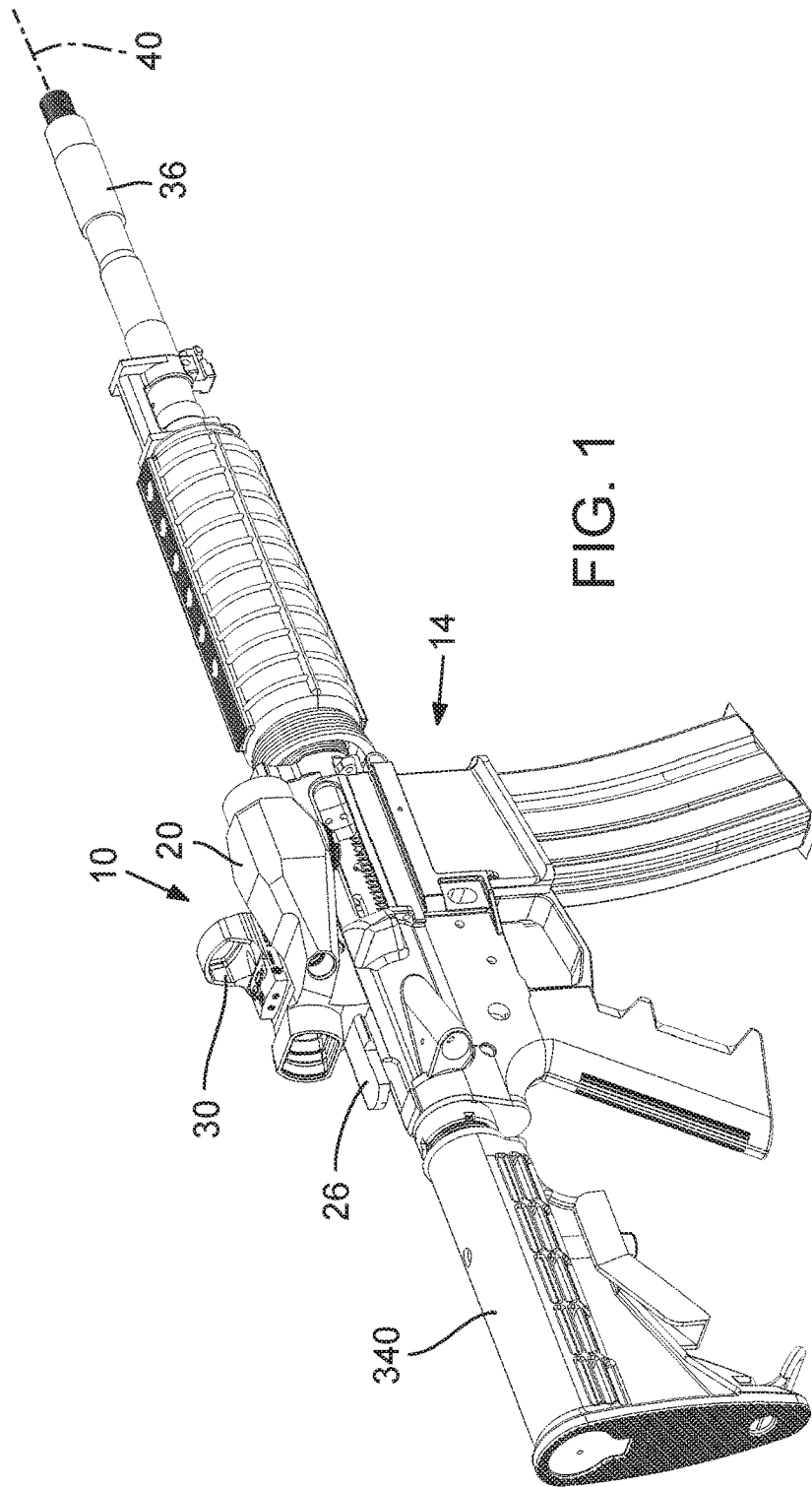

FIG. 1

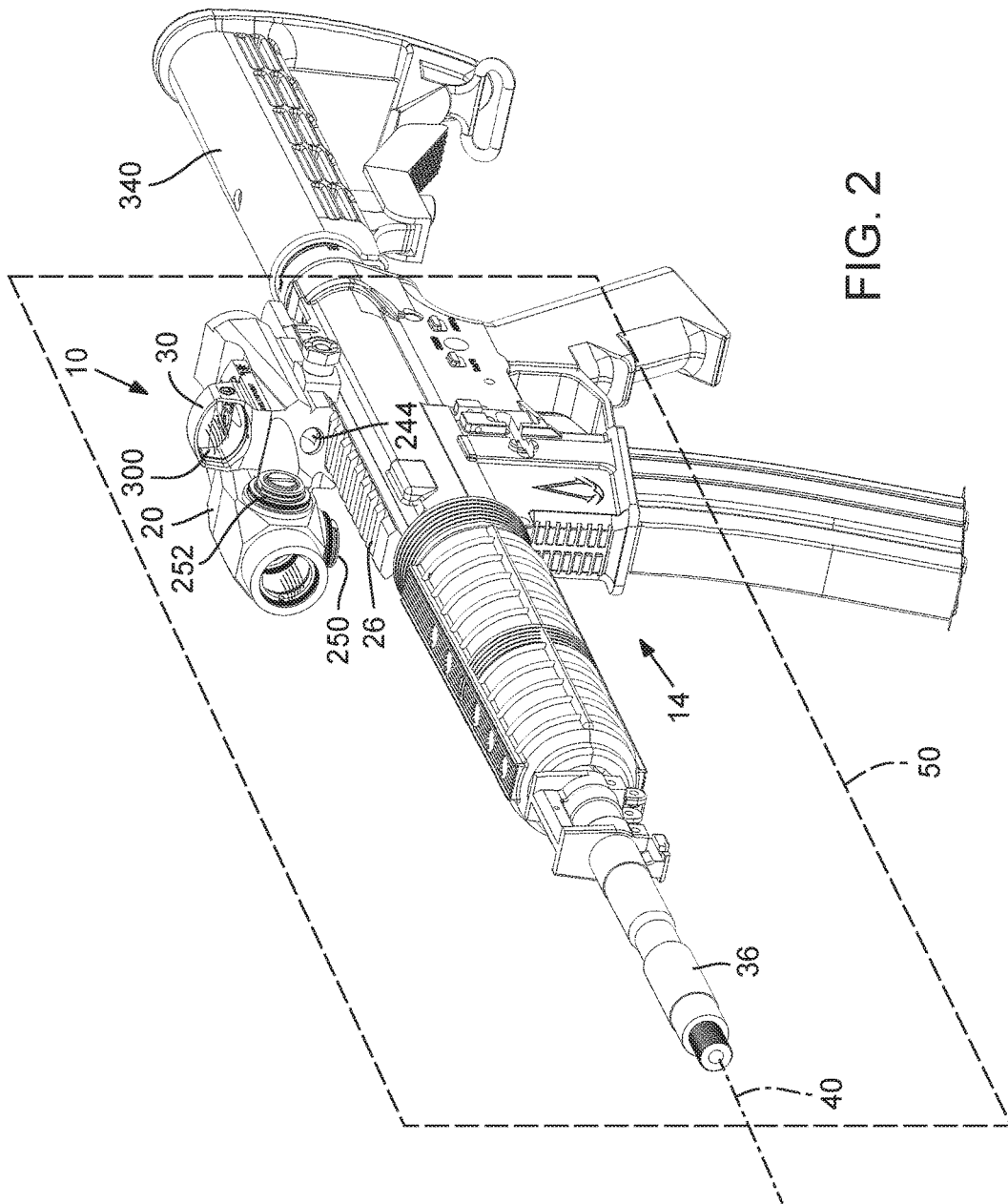
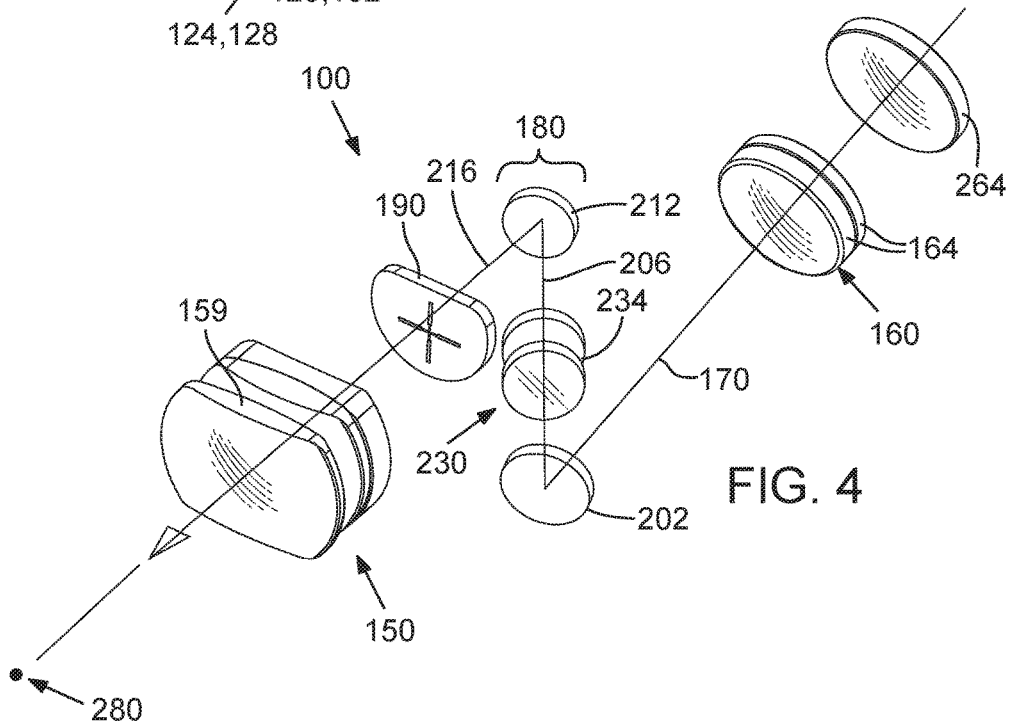
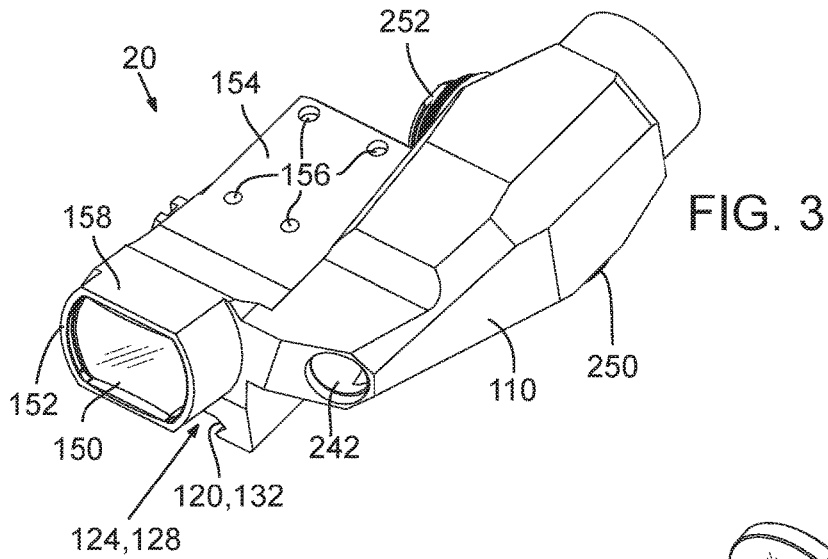

FIG. 2



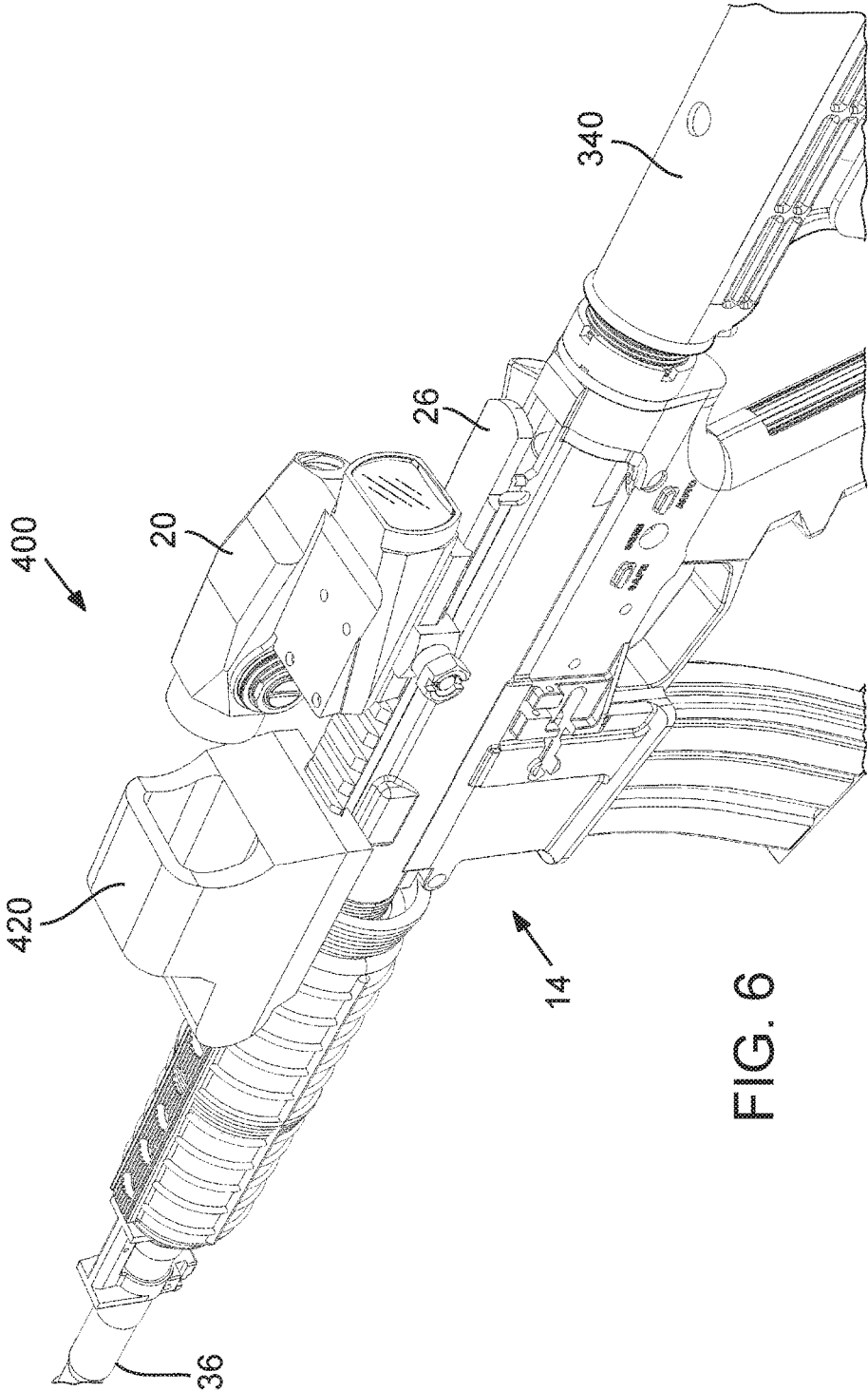

FIG. 6

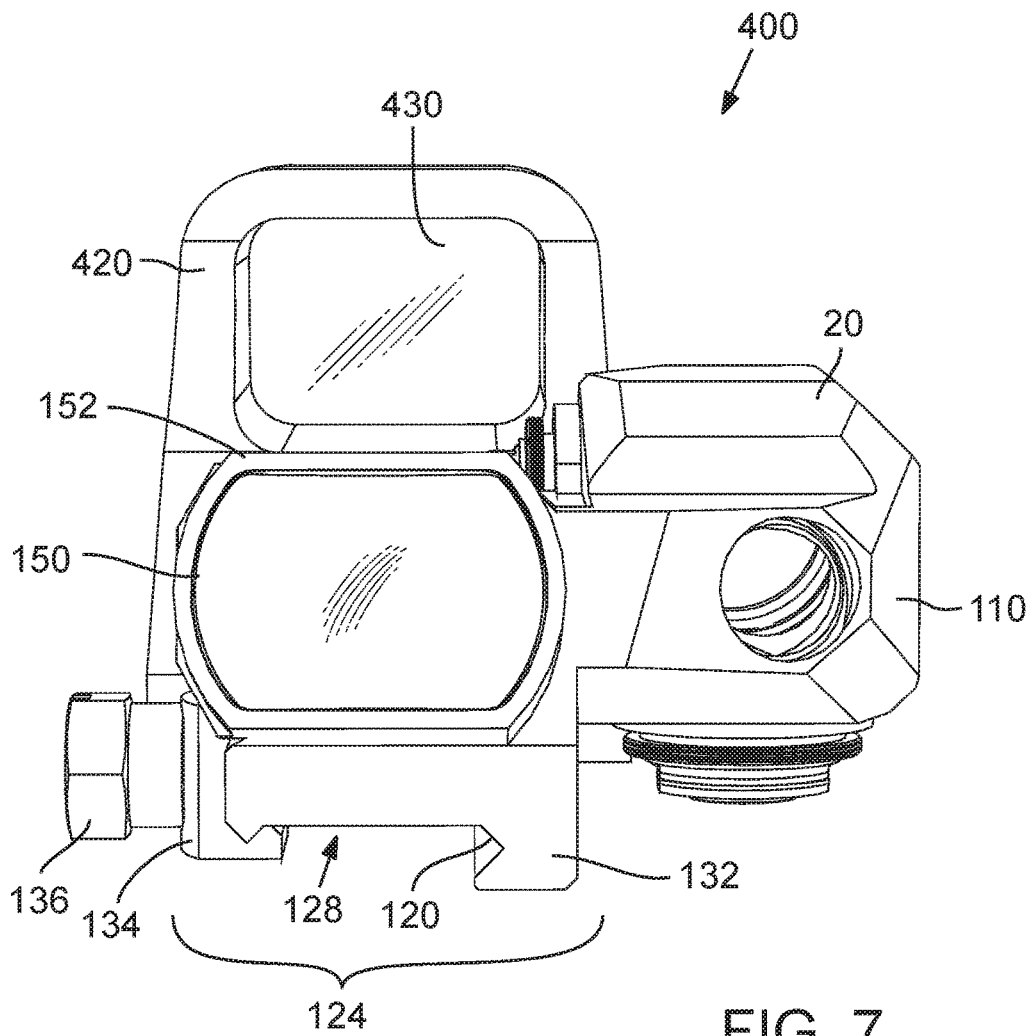

FIG. 7

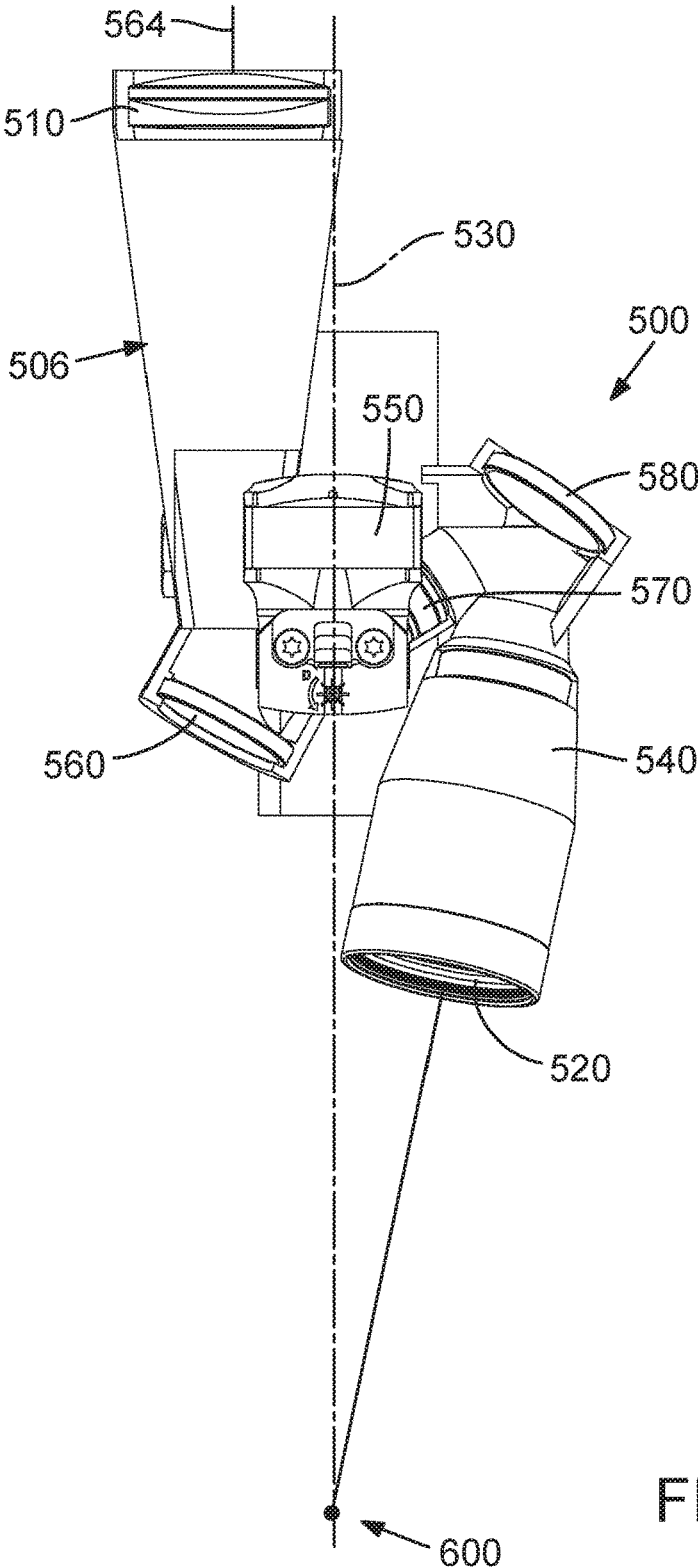

FIG. 8

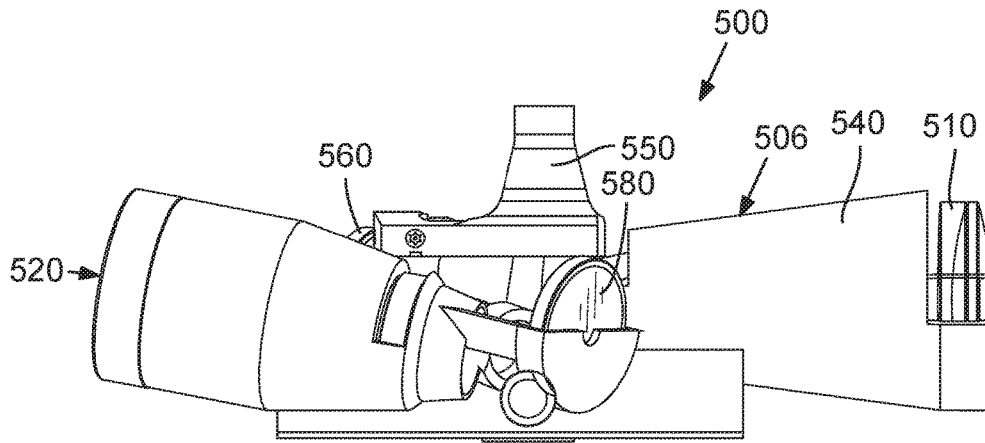

FIG. 9

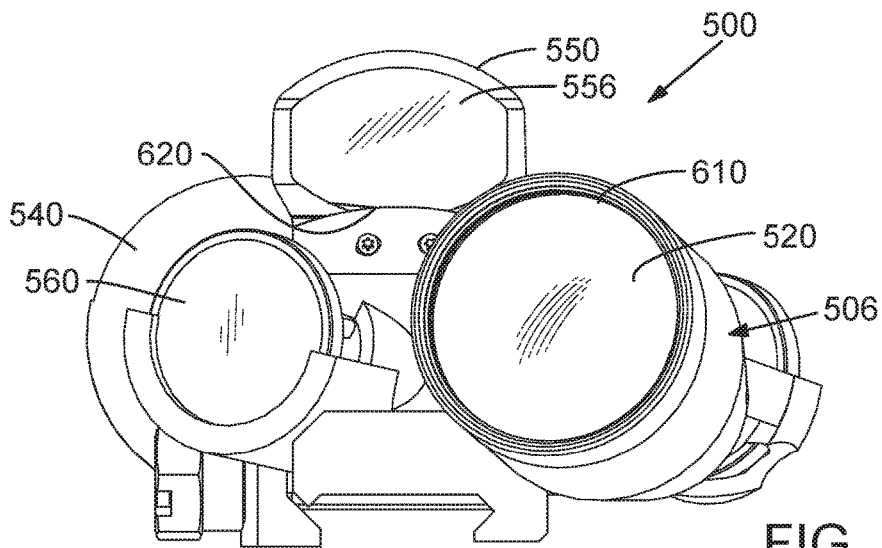

FIG. 10

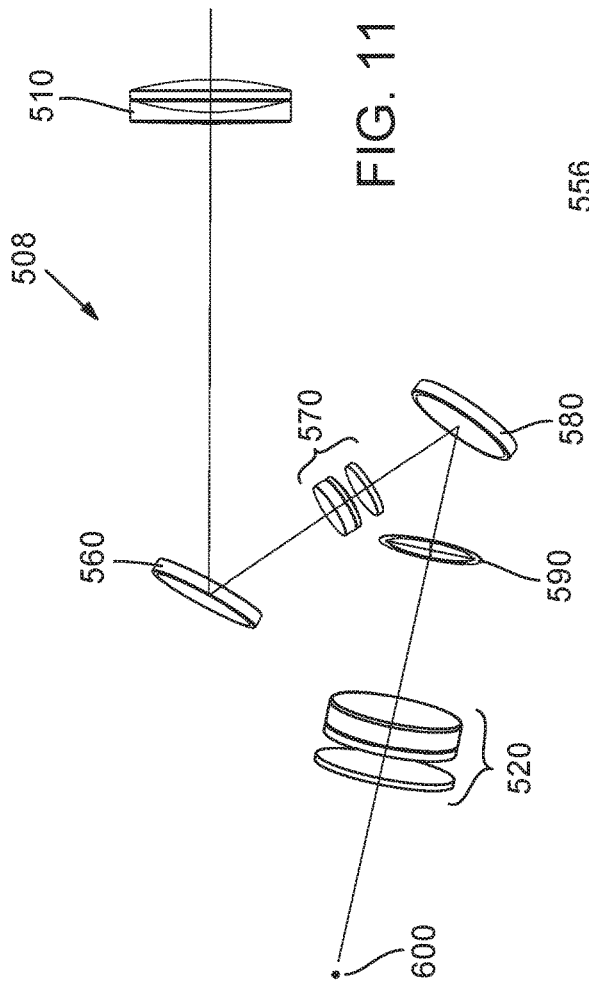

FIG. 11

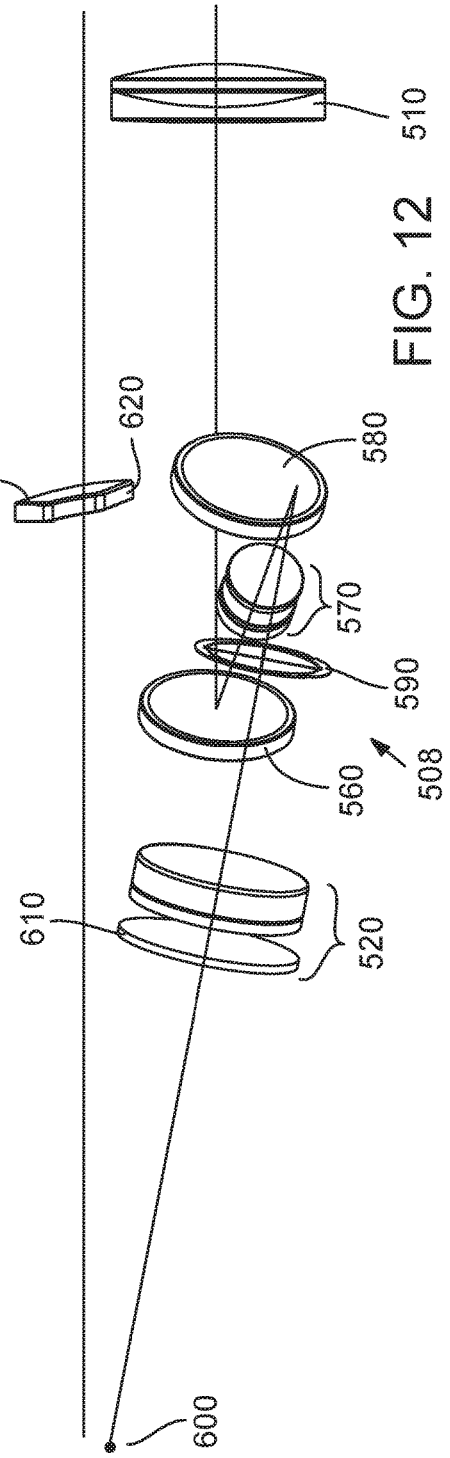
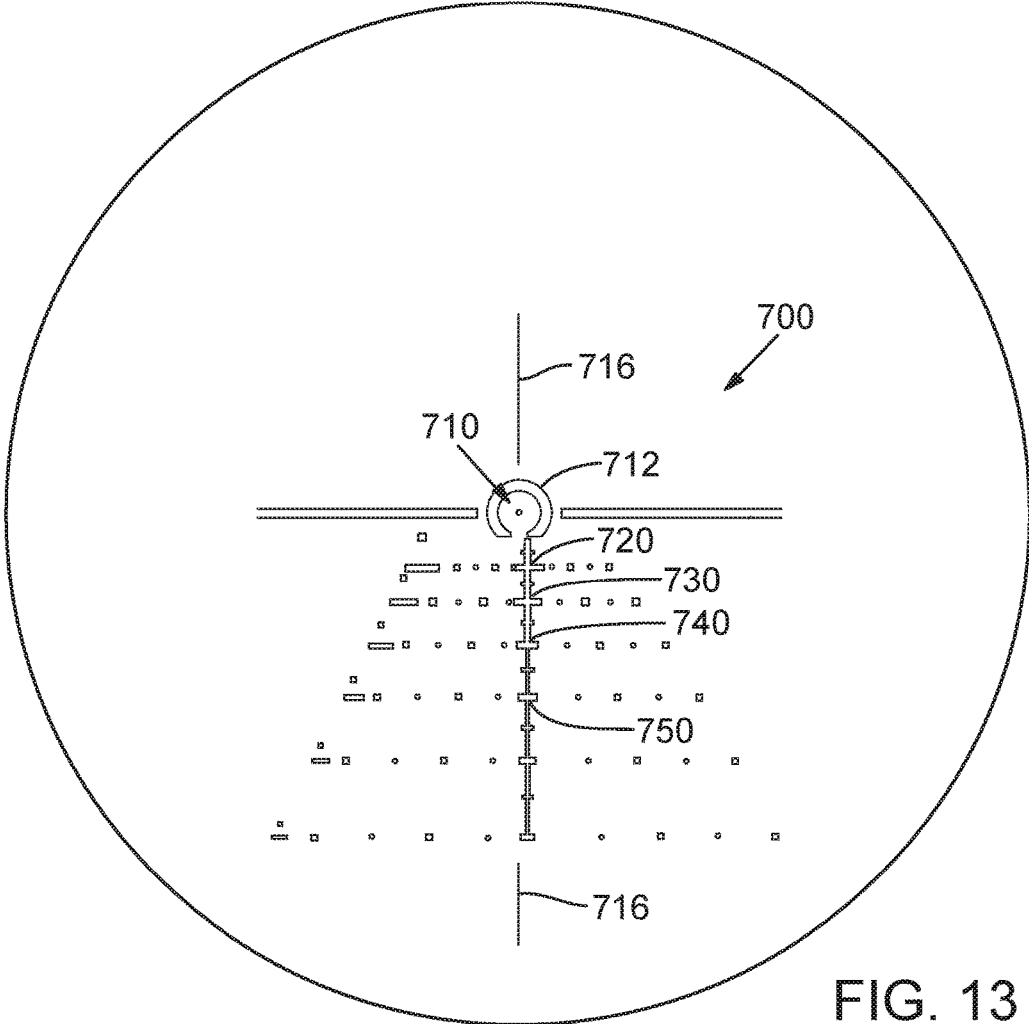
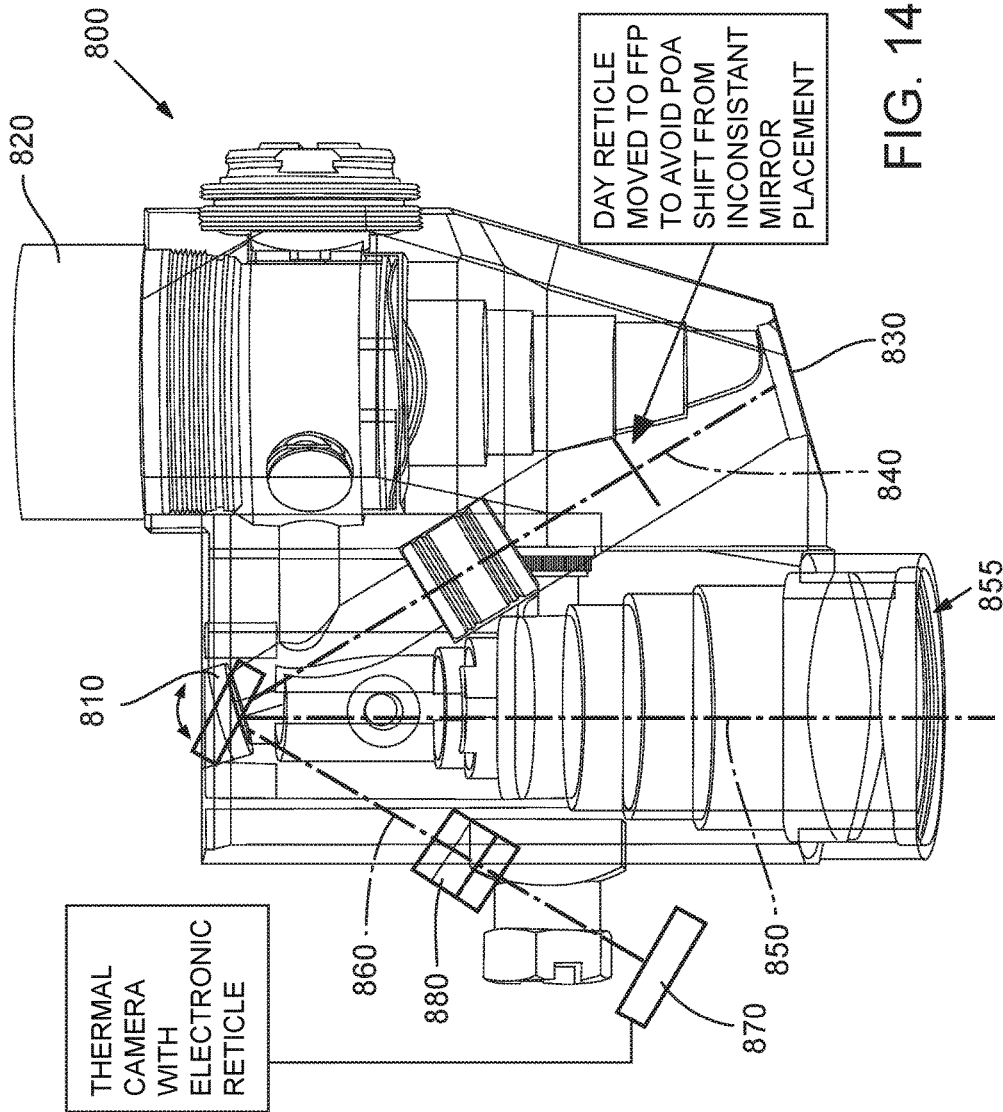

FIG. 12





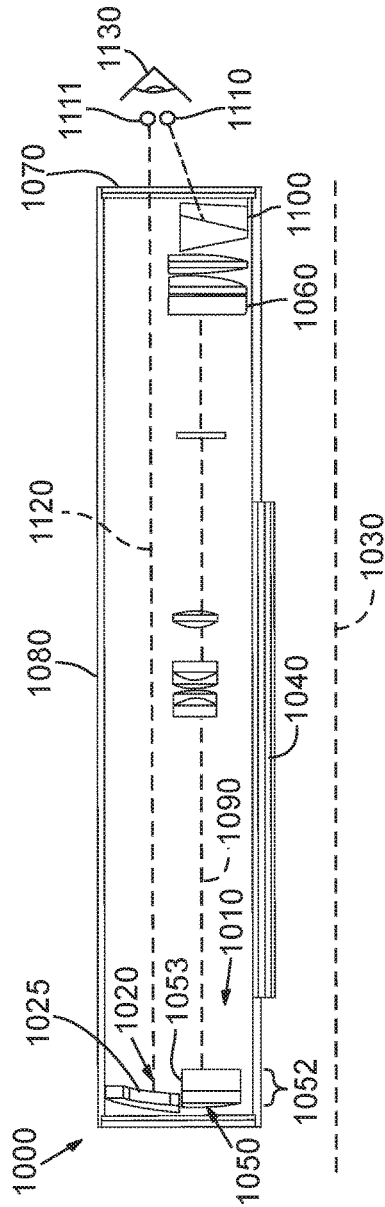

FIG. 15

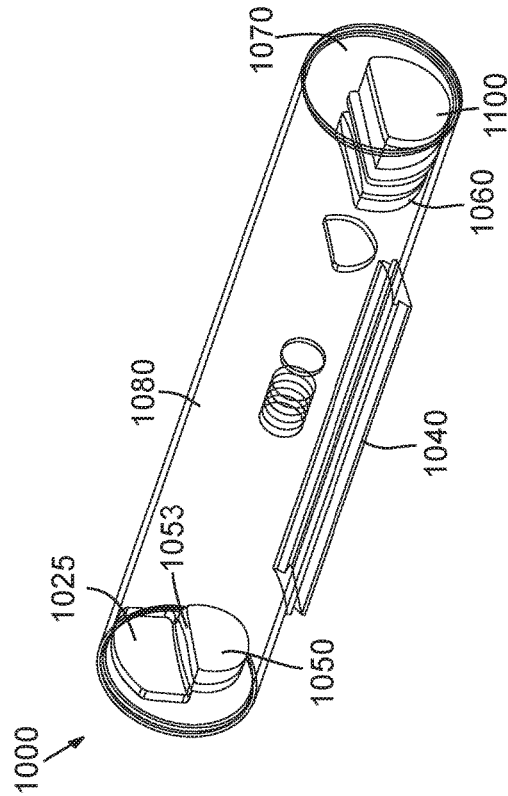

FIG. 16

DUAL FIELD OPTICAL AIMING SYSTEM FOR PROJECTILE WEAPONS

RELATED APPLICATION DATA

This application is a continuation-in-part of and claims the benefit under 35 U.S.C. § 120 from U.S. patent application Ser. No. 15/431,594, filed Feb. 13, 2017, which is a continuation-in-part of U.S. patent application Ser. No. 14/834,272 (now U.S. Pat. No. 9,568,277), filed Aug. 24, 2015, which is a continuation of U.S. patent application Ser. No. 13/843,445, filed Mar. 15, 2013 (now U.S. Pat. No. 9,115,958) and entitled "DUAL FIELD OPTICAL AIMING SYSTEM FOR PROJECTILE WEAPONS," the disclosures of which are each incorporated by reference herein in their entireties.

TECHNICAL FIELD

The field of the present disclosure relates to sighting systems for projectile weapons and, more particularly, to a telescopic sight designed for use in conjunction with a reflex sight or other non-magnifying sight.

BACKGROUND

Conventional riflescopes and other telescopic sights accomplish magnification changes by optical elements that are either movable along the optical path, or that are switched into and out of the optical path. Also known are sight designs utilizing switching mirrors and/or beam splitters for switching between one of two different optical systems alternately viewable through a common eyepiece. Some sights include optical paths for day and night operation, including visible and infrared channels, which may be combined and superimposed for viewing as a composite image. In many of these systems, components of the sight must be manually moved to switch between viewing modes, which makes the sight more complicated, prone to image instability or misalignment, cumbersome and slow for switching between modes, and prone to making noise.

U.S. Pat. No. 2,388,673 of Brown, U.S. Pat. No. 2,512,153 of Henvey et al., and U.S. Pat. No. 2,527,719 of Greenstein et al. describe dual optical power split-field telescopic sights utilizing different lenses or lens segments for upper and lower portions of the optical system. These telescopic sights utilize complex lens systems and optical prescriptions, and are limited by a shared eyepiece through which both fields are simultaneously viewed.

The present inventors have recognized a need for an aiming system that facilitates viewing a target scene through a telescopic sight and through a second sight having a different field of view or aiming capability, such as a non-magnifying reflex sight providing a wide field of view, very little field obstruction, and fast target acquisition. Such an aiming system may facilitate concurrent use of the second sighting device at a normal mounting height and viewable past the eyepiece of the telescopic sight, thereby allowing the viewer to change views between the telescopic sight and the second sighting device with little eye movement and essentially no head movement.

Various known systems utilize a miniature reflex sight (also known as a red-dot sight) mounted atop a telescopic sight, but the height of the viewing region of the reflex sight in such systems is generally much higher than the exit pupil of the telescopic sight and too high for achieving a cheek weld with the rifle stock (buttstock) as is desirable for stable

aiming. In such systems, substantial head movement is also needed to switch between the two sights. The required head movement can be cumbersome and slow, particularly when switching from the reflex sight to the telescopic sight and re-aligning the eye with the typically small exit pupil of the telescopic sight.

SUMMARY

In accordance with the present disclosure, a telescopic sight of a projectile weapon aiming system includes a housing supporting an optical system of the telescopic sight relative to a mounting surface of the sight, which may include an integrated mounting bracket or clamp at least partly formed in the housing. The optical system includes an objective lens system that produces an image of a distant target at a focal plane, and an eyepiece positioned rearward of the focal plane and along an optical axis of the objective lens system.

A light redirection device, such as a wedge prism, a Risley prism, or other suitable prism device, is positioned rearward of both the objective lens system and the eyepiece and along the optical axis. The light redirection device defines an eye point spaced apart rearwardly therefrom at which the image of the distant target is viewable. When the telescopic sight is mounted to the projectile weapon, the eye point is located at a place on a plane offset from the optical axis. In some embodiments, the eye point may be vertically offset from the optical axis such that a line intersecting the eye point does not intersect the eyepiece.

Preferably, the offset eye point facilitates concurrent use of a second sighting device, such as a non-magnifying reflex sight or holographic weapon sight, that may be viewable beyond the eyepiece, thereby allowing the viewer to change views between the telescopic sight and the non-magnifying sight with little eye movement and essentially no head movement. It may also enable a shooter to change views between the two sights without breaking cheek weld with a stock of the weapon.

In some embodiments, the non-magnifying sight and telescopic sight are each independently mountable in tandem on a common mounting rail of the projectile weapon. In other embodiments, the non-magnifying sight may share a common housing with the telescopic sight, where a viewing window of the non-magnifying sight is positioned above the objective to allow the viewer to quickly change views between the telescopic and non-magnifying sight. Other mounting arrangements may also be possible.

Additional aspects and advantages will be apparent from the following detailed description of preferred embodiments, which proceeds with reference to the accompanying drawings.

BRIEF DESCRIPTION OF THE DRAWINGS

FIG. 1 is a rear right side isometric view of an optical aiming system including a telescopic sight shown mounted to a rifle and a reflex sight mounted atop the telescopic sight, according to a first embodiment;

FIG. 2 is a front left side isometric view of the aiming system and rifle of FIG. 1;

FIG. 3 is an isometric view of the telescopic sight component of the aiming system of FIGS. 1-2, with the rifle and reflex sight omitted to show detail;

FIG. 4 is an isometric view of an optical system of the telescopic sight of FIG. 3, annotated to trace an optical path of the telescopic sight;

FIG. 5 is a left side elevation view of the optical system of the aiming system of FIGS. 1 and 2 illustrating the optical path of the telescopic sight and lines of sight from an eye point;

FIG. 6 is an isometric view of an optical aiming system including the telescopic sight of FIG. 4 and a holographic sight mounted to a common mounting rail of a rifle, according to another embodiment;

FIG. 7 is a rear perspective view of the optical aiming system of FIG. 6 with the rifle omitted;

FIGS. 8, 9 and 10 are respective top plan, right side elevation, and eyepiece end views of an optical aiming system according to yet another embodiment;

FIG. 11 is a top plan view of an optical system of the aiming system of FIGS. 8-10, with a reflex sight viewing window omitted;

FIG. 12 is a right side elevation view of the optical system of FIG. 11, together with a viewing window of a reflex sight of the aiming system of FIGS. 8-10;

FIG. 13 is a view of a reticle of the telescopic sight of FIGS. 1-7; and

FIG. 14 is a top view of a telescopic sight with a pivoting mirror for switching the optical path to an auxiliary display.

FIG. 15 is a schematic view of an optical aiming system including a telescopic sight and a non-magnifying sight mounted in a common housing, with a light redirection device positioned behind the eyepiece, according to another embodiment.

FIG. 16 is a schematic perspective view of the optical aiming system of FIG. 15.

DETAILED DESCRIPTION OF PREFERRED EMBODIMENTS

FIGS. 1 and 2 illustrate an optical aiming system 10 according to a first embodiment, shown mounted to a rifle 14. Aiming system 10 includes a telescopic sight 20 mounted to a mounting rail 26 of rifle 14, which may comprise a Picatinny rail (also known as a MIL-STD-1913 rail), which is a universal dovetail-shaped mounting rail commonly found on AR-15 rifles and other tactical rifles. In the embodiment illustrated in FIGS. 1 and 2, a non-magnifying reflex sight 30 is mounted atop telescopic sight 20. Telescopic sight 20 and non-magnifying sight are mounted in alignment with a bore of a barrel 36 of rifle 14, defining a line of initial trajectory 40 of rifle 14. Line of initial trajectory 40 lies within a vertical plane 50 (FIG. 2) that also longitudinally bisects mounting rail 26. As further described below with reference to FIGS. 3 and 4, an objective 160 of telescopic sight 20 is laterally offset (i.e. horizontally offset) relative to vertical plane 50.

It should be understood that the term “vertical plane” is used herein merely as convenient terminology for a frame of reference, and not to limit plane 50 to being exactly vertical relative to the horizon or gravity (i.e. plumb), even though when a rifle is in use the line of initial trajectory 40 and mounting rail 26 will desirably be arranged in a vertically stacked relationship as illustrated and described. As is known in the art, rifle 14 and aiming system 10 can be canted to the side together, thereby tilting vertical plane 50, albeit potentially impacting bullet drop compensation and parallax compensation functions of a reticle 190, 700 (FIGS. 4 and 13) of aiming system 10 described below. Also, aiming system 10 may be mounted on a side rail (not shown) or other non-standard mount that is not perfectly centered or horizontal relative to a normal shooting position. Moreover while the position of mounting rail 26 relative to vertical

plane 50 is a common attribute of a tactical rifle, it should be understood that mounting rail 26 or other mounting features or surfaces of a projectile weapon may not necessarily be centered on vertical plane 50. Thus, unless expressly stated in the claims, the use of the term “vertical plane” is not alone intended to limit the scope of the invention to an arrangement in which a mounting rail or other mounting features have the same shape or position as mounting rail 26 to the projectile weapon or to vertical plane 50, or to an exact placement of the vertical plane relative to mounting rail 26. As discussed below, the position of vertical plane 50 is determined in part by the line of initial trajectory 40 of the projectile weapon and in part by the location of an eye point 280 (FIGS. 4 and 5) of the telescopic sight 20.

FIG. 3 is an isometric view of telescopic sight 20 of aiming system 10, with reflex sight 30 removed, and FIG. 4 is an isometric view of an optical system 100 of telescopic sight. With reference to FIGS. 3 and 4, telescopic sight 20 includes a housing 110 that supports optical system 100 relative to a mounting surface 120 of housing 110. In the embodiment shown, mounting surface 120 comprises surfaces of a mounting clamp 124 (FIG. 7) having a longitudinal dovetail shaped slot 128. A fixed portion 132 of clamp 124 includes longitudinal reference surfaces providing primary lateral aiming alignment of telescopic sight 20 relative to mounting rail 26. Preferably, these reference surfaces and the entirety of fixed portion 132 are integrally formed directly in housing 110, by machining from stock material or otherwise. A movable portion of clamp 124 is formed by a clamp shoe 134 illustrated in FIG. 7, which is retained to fixed portion 132 by coupling bolt 136. In other embodiments, mounting surface 120 may take other shapes and forms providing a solid platform or reference that, with mounting rail 26 or other scope mount, precisely aligns telescopic sight 20 and optical system 100 relative to rifle 14 when telescopic sight 20 is mounted thereon. For example, in a conventional riflescope housing, the outer longitudinal surface of a main tube of the scope serves as the mounting surface, which is engaged by mounting rings that are secured to a mounting base on the gun's receiver. The term mounting surface may also encompass multiple surfaces on housing 110 that may or may not lie in a common plane, but achieve alignment of telescopic sight 20 using other mounting devices.

With reference to FIG. 3, an eyepiece 150 of optical system 100 is supported by housing 110 at a rearward opening in eyepiece end 152 thereof. When telescopic sight 20 is mounted on rifle 14, eyepiece 150 is aligned with vertical plane 50 (FIG. 2), such that an optical axis of eyepiece 150 is contained in vertical plane 50. In some other embodiments, such as those illustrated in FIGS. 8-10 discussed below, the optical axis of eyepiece 150 is not contained in vertical plane 50 but intersects vertical plane 50. Housing 110 also includes an auxiliary sight mounting platform 154 including a set of threaded mounting holes 156 formed on a top outer surface of housing 110 forward of eyepiece 150. Auxiliary sight mounting platform 154 is horizontal and is centered on and intersects vertical plane 50 when telescopic sight 20 is mounted on rifle 14. Auxiliary sight mounting platform 154 is preferably recessed horizontally below a top surface 158 of eyepiece end 152 of housing 110 (facing away from line of initial trajectory 40) and below an uppermost edge 159 (FIG. 4) of eyepiece 150 to position a miniature reflex sight or other non-magnifying sight or auxiliary sighting device at a desired or optimal height, as further explained below. Top surface 158 of

5

eyepiece end **152** may be flat, following the contour of an uppermost edge **159** of eyepiece **150** in which a top segment of round eyepiece lenses is removed to provide a clear line of sight for use of reflex sight **30**, as further described below with reference to FIG. **5**.

Continuing with reference to FIGS. **3** and **4**, optical system **100** includes an objective **160** comprising objective lenses **164**, which gather and focus light at a first (front) focal plane (FFP, not illustrated). In another embodiment (not shown), objective **160** may comprise a reflector or other suitable objective system. Objective **160** is offset horizontally relative to an eyepiece **150** of optical system **100** in the embodiment illustrated. A folded optical path **170** of optical system **100** extends from objective **160** to eyepiece **150**. The folded aspect of optical path **170** is created by a light redirection device **180** that receives light from objective **160** and causes an image of the field of view formed at a rear focal plane (RFP) (located approximately at the plane of an aiming reticle **190** of optical system **100**) to be offset horizontally from objective **160**. In particular, in the embodiment illustrated, light redirection device **180** includes a first reflective surface consisting of a first mirror **202** that receives light from the objective **160** and reflects it forwardly along a first path fold segment **206** toward a second reflective surface consisting of a second mirror **212**. The first path fold segment **206** may be angled downwardly relative to an optical axis of objective **160** (wherein the optical axis of objective **160** is coincident with a segment of optical path **170** between objective **160** and first mirror **202**), depending on the desired or required geometry of optical system **100**. Second mirror **212** receives light reflected by first mirror **202** and reflects the light rearward along a second path fold segment **216** that is angled upwardly away from the line of initial trajectory **40** to eyepiece **150**, as best shown in FIG. **5**. The light propagating along second path fold segment **216** forms, at the RFP, an image of the field of view of telescopic sight **20**. An erector system **230** including an image-erecting relay lens unit **234** positioned between objective **160** and eyepiece **150** erects an image of the field of view formed at FFP and focuses it at RFP. In the figures, backing caps supporting the mirrors **202**, **212** are omitted, providing a view through openings **242**, **244** (FIGS. **3** and **2**, respectively) in housing **110** through which mirrors **202**, **212** are installed.

In another embodiment (not illustrated), erector system **230** may include a power-varying relay lens system (zoom lens system) interposed between FFP and RFP and including at least one (and typically at least two or more) lens elements selectively movable along the optical path **170** to vary an optical magnification setting of telescopic sight **20**. When a zoom lens system is utilized, the aiming reticle **190** is preferably located at front focal plane FFP to maintain a constant relationship between markings on reticle **190** and the target scene regardless of the magnification setting of the zoom lens system.

Although light redirection device **180** is illustrated as a pair of mirrors **202**, **212**, in other embodiments (not shown) light redirection device may comprise a prism including first and second reflective surfaces. A prism system may be an image-erecting prism system, in which case relay lens system **234** can be omitted, and image-carrying light from objective **160** may be first focused at the plane of reticle **190**. In yet another embodiment, light direction device **180** includes an image sensor and an electronic image display device (not illustrated). In the case of an electronic image sensor and display combination, the image sensor would be located at a focal plane, namely either the focal plane of

6

objective **160** (FFP) or a focal plane of the erector system **230**, and the display would be located either at the focal plane of eyepiece **150** (rear focal plane RFP), or at the front conjugate of erector system **230**. Alternatively, light redirection device **180** might include a type of light guide, such as a light pipe (e.g. a bundle of fine aligned optical fibers forming an image pipe), which may bend the optical path without folding it longitudinally.

One or more of objective lenses **164** are slidably supported on housing **110** for movement transversely of an optical axis of the objective lenses relative to other elements of optical system **100**. In the embodiment illustrated, the lateral position of both objective lenses **164** is adjustable via elevation and windage adjustment screws **250**, **252** (FIG. **3**) that are supported on and extend through housing **110**. In alternative embodiments, another kind of adjustment mechanism may be employed. Adjustment screws **250**, **252** can be manually turned to drive objective lenses **164** in a direction transversely of (and preferably perpendicular to) their optical axis to thereby effect vertical and horizontal aiming adjustments to the line of sight of telescopic sight **20**, for sighting-in the aim point of telescopic sight **20** or compensating for bullet drop and/or wind effects, as further described in U.S. Pat. No. 7,827,723 of Zaderey et al., issued Nov. 9, 2010. Because objective lenses **164** are movable, they are not sealed to the housing **110**. Instead, a transparent sealing window **264** (illustrated in FIG. **4**) is fixed to housing **110** forward of objective lenses **164** and hermetically seals an interior of housing **110**. The horizontal offset of objective **160** relative to vertical plane **50** and mounting rail **26** enables elevation adjustment screw **250** to be positioned on an underside of housing **110** while remaining accessible for adjustment via a coin or screwdriver, which further enhances the low profile nature of telescopic sight **20** and avoids elevation adjustment screw **250** inhibiting the unaided (naked eye) field of view past housing **110**.

A left side elevation view of optical system **100** is illustrated in FIG. **5** together with optical elements of reflex sight **30**. With reference to FIGS. **4** and **5**, eyepiece **150** is positioned rearward of rear focal plane RFP (coplanar with reticle **190**) and defines an eye point **280** spaced rearwardly of eyepiece **150** at which the image of the field of view formed at RFP is visible through eyepiece **150**. First path fold segment **206** is angled downwardly toward second mirror **212** relative to an optical axis **284** of objective **160**. Second mirror **212** receives the light reflected by first mirror **202** and reflects the light rearward along second path fold segment **216**, which is angled upwardly away from initial line of trajectory **40** and toward a horizontal plane containing the optical axis **284** of objective **160**. This down and up folded optical path **170** assists in lowering the position of eyepiece **150** relative to the weapon. In the embodiment illustrated, optical path **170** is folded in both the horizontal and vertical axes, though in other embodiments (not illustrated), optical path **170** may be folded only horizontally or in only a vertical plane **50**.

When telescopic sight **20** is mounted to rifle **14**, eye point **280** is located at a place on vertical plane **50** (FIG. **2**) such that a line **290** (FIG. **5**) parallel to the line of initial trajectory **40** and intersecting eye point **280** does not intersect eyepiece **150**. In the embodiment illustrated in FIGS. **1-7**, eyepiece **150** is truncated and flat along its uppermost edge **159** (i.e., a round lens that has been cut, ground, or otherwise truncated or relieved to remove a section) to allow a clear horizontal line of sight from eye point **280** through a viewing window **300** of reflex sight **30** mounted forwardly of eyepiece **150**. The truncated uppermost edge **159** of eyepiece

may also enable a relatively large range of eye positions for use of reflex sight (beyond eye point **280**), which may facilitate fast target acquisition in close-quarter tactical situations. Eye point **280** is preferably located just above a horizontal plane **294** tangent to uppermost edge **159** of eyepiece **150**, which faces away from line of initial trajectory **40** when telescopic sight **20** is mounted to rifle **14** or another projectile weapon. Skilled persons will appreciate that eye point **280** may be any point within an exit pupil of telescopic sight **20** at which a viewer's eye **330** may be located to view the entire image of the field of view of telescopic sight **20**.

Reflex sight **30** includes a light source **310**, such as an LED, which is positioned near a focal point of viewing window **300**, which is curved and includes a partial reflector in the form of a dichroic reflective surface **314**. The dichroic reflective surface **314** of viewing window **300** selectively reflects the wavelength of illumination emitted by light source **310** while passing other wavelengths of light, so as to reflect collimated light **320** toward the viewer's eye **330** while allowing the viewer to see a distant target scene through viewing window **300**. As is well known in the art, this arrangement results in an image of an aiming mark or reticle formed by light source **310** to appear focused at a distance forward of reflex sight **30** and superimposed on the target scene viewed through viewing window **300** to enable accurate aiming across a relatively wide range of head and eye positions at which the collimated light is received by the viewer's eye **330**.

Viewing window **300** is positioned predominantly above the horizontal plane **294** when both reflex sight **30** and telescopic sight **20** are mounted to rifle **14**, such that both telescopic sight **20** and reflex sight **30** can be used to aim rifle **14** with essentially no movement of the viewer's head. In practice, a small portion of the base of viewing window **300** may lie below horizontal plane **294**, which will only slightly reduce the effective range of eye positions at which reflex sight **30** can be used for aiming. The shooter or viewer may easily change between a (magnified) viewing line of sight **334** of telescopic sight **20** and a non-magnified viewing line of sight **336** through reflex sight **30** merely by rotating the viewer's eye **330** within its socket and with essentially no head movement. Thus, in practice when switching between sights **20** and **30**, the eye point **280** of telescopic sight **20** (along viewing line of sight **334**) may be slightly below and spaced apart from an eye point of viewer's eye **330** when viewing through reflex sight along viewing line of sight **336**. Alternatively, both sights **20**, **30** may be viewed from coincident eye points. When the telescopic sight **20** and reflex sight **30** are mounted to mounting rail **26** of rifle **14**, a centroid of the surface area of viewing window **300** is preferably located between 1.3 and 1.75 inches above mounting rail **26**, and more preferably between 1.3 and 1.6 inches or between 1.4 and 1.5 inches above mounting rail **26**, which is an ideal height for allowing a shooter to form a cheek weld with a stock **340** (FIG. 1) of rifle **14**. Thus, telescopic sight **20** and reflex sight **30** may be sequentially used for aiming without breaking the cheek weld.

FIG. 6 illustrates an aiming system **400** according to another embodiment, in which a non-magnifying holographic weapon sight **420** and telescopic sight **20** are independently mounted to mounting rail **26** of rifle **14** in tandem. Holographic weapon sight may be any of a variety of holographic sights sold by EOTech, a subsidiary of L-3 Communications located in Ann Arbor, Mich. In the tandem mounting arrangement, each of telescopic sight **20** and holographic weapon sight **420** is separately removable and

mountable to the common mounting rail **26** independently of the other. In this arrangement, the sights are independently sighted in. The sights can be targeted at different sighted-in ranges. Or if a common sighted-in range is desired, the second one of the sights to be mounted can be sighted in merely by positioning its aiming mark at the same place on the target scene as the other sight, which has been previously sighted-in.

FIG. 7 is a rear perspective view of aiming system **400** illustrating how a viewing window (optic **430**) is in a vertically stacked relationship with eyepiece **150**. In practice, the fields of view of telescopic sight **20** and the non-magnifying sight (either holographic weapon sight **420**, or in the embodiment of FIGS. 1-7, reflex sight **30**) may be stacked directly adjacent each other to form a composite image in which the top portion of the composite image is a wide-field of view of the scene with no magnification and the bottom portion of the composite image is a narrow field of view of a magnified image of the same scene of the distant target. In some embodiments, the two images may be slightly spaced apart or divided by an edge of eyepiece end **152** of housing **110** to provide a distinct separation between images and avoid confusion.

Other types of non-magnifying sights may also be utilized with telescopic sights according to the present disclosure. For example, reflex sights having a collimated light source and a flat partially reflective viewing window may be utilized. Still other non-magnifying sights, such as iron sights, may be usable with telescopic sights and aiming systems (including a secondary reflex sight or other non-magnifying sight). Mounting a non-magnifying sight, such as reflex sight **30** or holographic weapon sight **420**, at a normal mounting height in the range of 1.3 to 1.75 inches enables the user to co-witness the non-magnifying sight with conventional iron sights (not illustrated), which may include a front iron sight located forward of aiming system **10** toward a muzzle end of barrel **36**, and a rear iron sight located behind the front iron sight and behind or forward of aiming system **10**.

Skilled persons will appreciate that the aiming systems **10** and **400** of FIGS. 1-7 are right-handed and designed to be viewed using the shooter's right eye, and their configuration provides a right-handed shooter with little impediment to viewing the target scene with a naked left eye. However, if the same aiming systems **10** and **400** were to be used by a left-handed shooter, the objective **160** and the portion of housing **110** associated therewith would tend to block the unaided field of view of the shooter's right eye. A left-handed embodiment of the aiming systems (not shown) is also contemplated, in which the objective **160** is horizontally offset to the left of the vertical plane **50**.

FIGS. 8, 9 and 10 show respective top, right side, and eyepiece end views of an aiming system **500** according to yet another embodiment, including a telescopic sight **506** having an objective **510** offset laterally to the left of a vertical plane (illustrated by centerline **530** in FIG. 8) and an eyepiece **520** offset laterally to the right of vertical plane **530**. Portions of a housing **540** of telescopic sight **506** are cut away to reveal portions of an optical system **508** of telescopic sight **506**. FIG. 11 is a top view of optical system **508** of telescopic sight, and FIG. 12 is a side elevation view of optical system **508**. FIG. 12 also illustrates a viewing window **556** of a reflex sight **550** of aiming system **500**.

With reference to FIGS. 8-12, reflex sight **550** is mounted along a central portion of the housing **540** of telescopic sight **506** between objective **510** and eyepiece **520**. A first mirror **560** receives light from objective **510** and reflects it for-

wardly and across vertical plane 530 and at a slight downward angle relative to the optical axis 564 of objective 510 through an image-erecting reflex lens unit 570 to a second mirror 580. Second mirror 580 reflects the light rearward and toward vertical plane 530 to a rear focal plane (RFP) located at or near a reticle 590 (FIGS. 11 and 12). Eyepiece 520 defines an eye point 600 rearward of eyepiece 520 at which the image at the RFP is visible. The eye point 600 is located at a place on vertical plane 530 such that a line parallel to the initial line of trajectory (not illustrated) extends through viewing window 556 of reflex sight and does not intersect eyepiece 520. Due to the lateral offset of eyepiece 520, eye point 600 may, in some embodiments, be lower than a horizontal plane (not illustrated) tangent to an uppermost edge 610 (FIG. 12) of eyepiece 520, yet a horizontal line of sight intersecting eye point 600 and contained in vertical plane 530 does not intersect eyepiece 520. A similar lateral arrangement of eyepiece 520 may also enable reflex sight 550 to be mounted relatively low on telescopic sight 506 such that a lower edge 620 (FIG. 12) of viewing window 556 is vertically lower than the uppermost edge 610 of eyepiece 520 without occluding an effective field of view through viewing window 556, as best illustrated in FIG. 10.

In still other embodiments (not illustrated) a telescopic sight with a folded optical path may include a small diameter objective centered on the weapon (on vertical plane 530); and with an eyepiece that is laterally offset to the side of vertical plane 530, similarly to telescopic sight 506 of FIGS. 8-12. A small diameter objective may allow reflex sight to be mounted atop the telescopic sight while maintaining a height of a centroid of the viewing window of reflex sight at a height of between 1.3 and 1.75 inches above the mounting rail (not shown). Like the embodiment of FIGS. 8-12, the eyepiece is angled inwardly and upwardly to provide an eye point that allows both the telescopic sight and the reflex sight mounted thereon to be viewed from essentially the same head position and with little eye movement, and to provide other benefits described above with respect to FIGS. 8-12 while avoiding the parallax issues addressed by the reticle described below.

FIG. 13 is a view of a reticle 700 usable in place of reticle 190 of telescopic sight 20 (FIGS. 4 and 5). With reference to FIG. 13, reticle 700 includes a primary aiming mark 710 at the center of a horseshoe shape 712. A vertical aiming axis (shown partially by dimension line 716, which forms no part of reticle 700) extends through aiming mark 710. Reticle 700 is designed so that, when telescopic sight 20 is sighted-in with primary aiming mark 710 accurately aiming at a point of impact of the projectile at the sighted-in distance (for example 100 or 200 yards), holdover aiming marks 720, 730, 740, 750 provide compensation for different ranges (e.g. 300, 400, 500, and 600 yards, etc.). Holdover aiming marks 720, 730, 740, and 750 are spaced below primary aiming mark 710 and laterally offset to the right side of vertical aiming axis to compensate for parallax induced by the horizontal offset of the objective 160 to the right of vertical plane 50 and line of initial trajectory 40 and an angled line of sight. More particularly, the position of reticle 700 in telescopic sight 20 (and particularly aiming marks 710, 720, 730, 740, and 750) cooperates with objective 160 to define a line of sight from objective 160 that is angled horizontally inward toward vertical plane 50 when telescopic sight 20 is mounted to rifle 14. Skilled persons will appreciate that this angled line of sight induces left-to-right parallax error at ranges different from the sighted-in range, compensated by laterally offsetting holdover aiming marks

720, 730, 740, 750 relative to vertical axis 716 of reticle 700, as discussed above. The position of holdover aiming marks 720, 730, 740, 750 may also be designed to compensate for spin-drift of the bullet at ranges beyond the sighted-in range.

FIG. 14 is a top view of a telescopic day/night sight 800 similar to telescopic sight of FIGS. 1-7, but in which a second mirror 810 is pivotable to switch the field of view of telescopic sight 800 between a day mode and a night mode. In day mode, the second mirror 810 is in a first position to receive visible light (which has been gathered by objective 820 and reflected by first mirror 830 along a first path fold segment 840) and to reflect the visible light along a second path fold segment 850 to a rear focal plane (RFP) for viewing via the common eyepiece 855. In night mode, the second mirror 810 is pivoted or otherwise moved to a second position, to receive light along a third optical path segment 860 from a display unit 870 of an auxiliary viewing device, such as a thermal imaging device, infrared scope, or other night vision sight, or from another type of video or image input device. In night mode, the image of the display is formed at RFP for viewing via eyepiece 855. A relay lens unit 880 (erector lenses) is provided in third optical path segment 860 between display unit 870 and second mirror 810. In some embodiments, telescopic day/night sight 800 may be additionally utilized with a reflex sight or other non-magnifying sight (not illustrated).

FIGS. 15 and 16 illustrate another embodiment of an optical aiming system 1000 that is mountable to a rifle or other weapon in the same or similar fashion as the optical aiming system 10 illustrated. The optical aiming system 1000 includes a light redirection device 1100 positioned rearward of the eyepiece 1060 to offset the eye point 1110 and allow the shooter to view the target through the riflescope while also allowing the shooter to see around, above, or below the riflescope for an unobstructed view of the target. Additional details of the optical aiming system 1000 are described below with reference to FIGS. 15 and 16. To avoid repetition, certain components of the optical aiming system 1000, such as a reticle, an erector assembly, and/or additional lenses, may not be shown or described in detail to avoid obscuring more pertinent details of the embodiment. One having ordinary skill in the art would understand that such details (and others) described in previous embodiments illustrated in FIGS. 1-14 may be combined with the specific details of the embodiment in FIGS. 15 and 16.

With collective reference to FIGS. 15 and 16, the optical aiming system 1000 includes a telescopic sight 1010 and a non-magnifying sight 1020 (such as a reflex sight) positioned above the telescopic sight 1010. As mentioned previously and further discussed below, the telescopic sight 1010 and the non-magnifying sight 1020 may share a common housing 1080 in some embodiments (as illustrated in FIGS. 15 and 16), or may be independently mountable to the rifle as separate components (as shown in FIG. 1). In a similar fashion as described in FIG. 1, the telescopic sight 1010 and non-magnifying sight 1020 are mounted via a mount 1040 in alignment with a bore of a barrel of rifle, defining a line of initial trajectory 1030 of the rifle. As is further described below, the aiming system 1000 may facilitate concurrent use of the non-magnifying sight 1020 at a normal mounting height and the telescopic sight 1010, thereby allowing the viewer to change views between the telescopic sight 1010 and the non-magnifying sight 1020 with little eye movement and essentially no head movement.

The telescopic sight 1010 includes a housing 1080 that supports optical aiming system 1000 relative to a mounting surface of the rifle. The optical aiming system 1000 includes

an objective **1050** comprising objective lenses **1052**, which gather and focus light at a first (front) focal plane (FFP, not illustrated). In another embodiment (not shown), objective **1050** may comprise a reflector or other suitable objective system. The optical aiming system **1000** further includes an eyepiece **1060** supported by the housing **1080** at a rearward opening toward a viewing end **1070** of the housing **1080**. When the telescopic sight **1010** is mounted to the rifle, the eyepiece **1060** and the objective **1050** are substantially aligned along an optical axis **1090**.

The optical aiming system **1000** further includes a light redirection device **1100** positioned rearward of the eyepiece **1060** along the optical axis **1090**. In some embodiments, the light redirection device **1100** may be a wedge prism that deflects or refracts the light received from the objective (i.e., an image of the target) at a fixed angle. In some embodiments, the fixed angle of the wedge prism **1100** may range between 4-8 degrees, depending on the dimensions of the optical component and riflescope. In other embodiments, a six-degree wedge prism **1100** may be used to provide sufficient offset and allow the shooter to see over all optical components of the telescopic sight **1010** and through non-magnifying sight **1020**. Preferably, the wedge prism **1110** is positioned in as close relation to the eyepiece **1060** as possible, offsetting the eye point **1110** far enough for the shooter to see around, above, or below the riflescope **1000** for an unobstructed view of the target.

With particular reference to FIG. **15**, the wedge prism **1100** refracts the image of the target, as acquired through the telescopic sight **1010**, rearwardly and upwardly toward an eye point **1110** spaced apart rearwardly from the prism **1100**. During use, a viewer may view an image of the distant target at the eye point **1110** when the telescopic sight **1010** is mounted to the projectile weapon. As shown in FIG. **15**, the eye point **1110** may be located at a place on a plane vertically offset from the optical axis **1090** such that a line intersecting the eye point **1110** does not intersect the eyepiece **1060**, the objective **1050**, or any other optical component of the telescopic sight **1010**.

With reference to FIG. **15**, the housing **1080** further includes a non-magnifying sight **1020** mounted in a vertically stacked relationship relative to the objective **1050** and vertically offset from the optical axis **1090**. In some embodiments, the objective **1050** and the eyepiece **1060** are each truncated and flat along an uppermost edge **1053** (i.e., a round lens that has been cut, ground, or otherwise truncated or relieved to remove a section) to provide a clear horizontal line of sight from eye point **1111** through a viewing window (or optic) **1025** of non-magnifying sight **1020**. The truncated uppermost edge **1053** of objective **1050** may also enable a relatively large range of eye positions for use of the non-magnifying sight (beyond eye point **1111**), which may facilitate fast target acquisition in close-quarter tactical situations.

Viewing window **1025** is positioned predominantly above the optical axis **1090** when both non-magnifying sight **1020** and telescopic sight **1010** are mounted to the rifle such that both telescopic sight **1010** and non-magnifying sight **1020** can be used to aim the rifle with essentially no movement of the viewer's head. The shooter or viewer may easily change between a (magnified) viewing line of sight of telescopic sight **1010** and a non-magnified viewing line of sight **1120** through non-magnifying sight **1020** merely by rotating the viewer's eye **1130** within its socket and with essentially no head movement. Thus, in practice when switching between sights **1010** and **1020**, the eye point **1110** of telescopic sight **1010** may be slightly below and spaced apart from an eye

point **1111** of viewer's eye **1130** when viewing through non-magnifying sight **1020** along viewing line of sight **1120**. In some embodiments, both sights **1010**, **1020** may be viewable from coincident eye points.

It will be obvious to those having skill in the art that many changes may be made to the details of the above-described embodiments without departing from the underlying principles of the invention. For example, while the foregoing description of the aiming system **10** is presented in the environment of a tactical rifle, it should be understood that aiming systems and other aspects of the devices described herein may be used in conjunction with other projectile weapons, such as hunting rifles, handguns (pistols), shotguns, archery bows, crossbows, and grenade launchers, for example, and for other sighting needs unrelated to projectile weapons, such as observation, surveying, and the like. The scope of the present invention should, therefore, be determined only by the following claims.

The invention claimed is:

1. A projectile weapon aiming system comprising:
 - a telescopic sight including a housing having a mounting surface that facilitates mounting the telescopic sight on a projectile weapon, the housing supporting an optical system of the telescopic sight and positioning the optical system relative to the mounting surface, the optical system forming at a focal plane an image of a distant target, and the optical system including:
 - an objective having an optical axis, the objective gathering light that forms the image of the distant target, an eyepiece positioned rearward of the objective and the focal plane, and
 - a light redirection device positioned rearward of the eyepiece, the light redirection device receiving light from the image via the objective and redirection the rearwardly toward an eye point at which the image of the distant target is viewable, wherein, when the telescopic sight is mounted to the projectile weapon, the eye point is located at a place above a horizontal plane tangent to an uppermost edge of the eyepiece, the horizontal plane vertically offset from the optical axis such that a line parallel to the optical axis and intersecting the eye point does not intersect the eyepiece; and
 - a second sight positioned within the housing above the horizontal plane such that the line extends through the second sight and to the distant target without intersecting the optical axis, so that both the telescopic sight and the second sight can be used to aim the projectile weapon with essentially no head movement.
2. The projectile weapon aiming system of claim 1, wherein the light redirection device includes a wedge prism.
3. The projectile weapon aiming system of claim 1, wherein the second sight is a non-magnifying sight, the non-magnifying sight including a viewing window positioned predominantly above the horizontal plane.
4. The projectile weapon aiming system of claim 1, wherein the distant target is viewable via the second sight from a second eye point that is spaced apart from the eye point from which the image of the distant target viewable via the telescopic sight.
5. The projectile weapon aiming system of claim 3, wherein the non-magnifying sight is a reflex sight, and the viewing window is a partial reflector.
6. The projectile weapon aiming system of claim 3, wherein the non-magnifying sight is a holographic weapon sight.

13

7. The projectile weapon aiming system of claim 1, wherein the optical system of the telescopic sight further includes an aiming reticle located at the focal plane.

8. The projectile weapon aiming system of claim 1, further comprising an erector assembly disposed between the objective and the eyepiece.

9. The projectile weapon aiming system of claim 1, wherein the light redirection device alters the optical path of the image rearwardly and upwardly toward the eye point.

10. A projectile weapon aiming system, comprising:

a telescopic sight including a housing having a mounting surface that facilitates mounting the telescopic sight on a projectile weapon, the housing supporting an optical system of the telescopic sight and positioning the optical system relative to the mounting surface, the optical system forming at a focal plane an image of a field of view of the telescopic sight, the optical system including:

an objective having an optical axis,
a light redirection device that receives light from the objective and redirects the light rearwardly along an optical path segment angled upwardly away from the optical axis, and

an eyepiece positioned rearward of the objective and the focal plane, the optical system defining an eye point spaced rearwardly from the eyepiece at which the image of the field of view is visible through the eyepiece, wherein the eye point is located on a line that is parallel to the optical axis of the objective but does not intersect the eyepiece; and

a second sight positioned in relation to the telescopic sight so that the line intersects the second sight, such that, when the telescopic sight is mounted to the projectile weapon via the mounting surface, a user can utilize both the telescopic sight and the second sight to aim the projectile weapon with a single eye and can switch between the telescopic sight and the second sight with essentially no head movement.

11. The projectile weapon aiming system of claim 10, wherein the light redirection device includes a prism.

12. The projectile weapon aiming system of claim 11, wherein the prism is located rearward of the eyepiece.

13. The projectile weapon aiming system of claim 10, wherein the light redirection device includes a wedge prism positioned rearward of the eyepiece.

14. The projectile weapon aiming system of claim 10, wherein the second sight is positioned within the housing.

15. The projectile weapon aiming system of claim 10, wherein the field of view is viewable via the second sight from a second eye point that is spaced apart from the eye point from which the image of the field of view of the telescopic sight is viewable.

16. The projectile weapon aiming system of claim 10, wherein the second sight is a non-magnifying sight, the non-magnifying sight including a viewing window positioned predominantly above a horizontal plane that is parallel to the optical axis and tangent to an upper edge of the eyepiece that faces away from an initial line of trajectory of the projectile weapon when the telescopic sight is mounted to the projectile weapon via the mounting surface.

14

17. The projectile weapon aiming system of claim 16, wherein the non-magnifying sight is a reflex sight, and the viewing window is a partial reflector.

18. The projectile weapon aiming system of claim 16, wherein:

the eyepiece includes at least one eyepiece lens that is truncated to form the upper edge of the eyepiece; and the objective includes at least one truncated objective lens.

19. The projectile weapon aiming system of claim 10, wherein the optical system of the telescopic sight further includes an aiming reticle located at the focal plane.

20. The projectile weapon aiming system of claim 10, further comprising an erector assembly disposed between the objective and the eyepiece.

21. The projectile weapon aiming system of claim 10, wherein the second sight and the telescopic sight are independently mounted in tandem on a common mounting rail of the projectile weapon and separately removable from the common mounting rail.

22. A projectile weapon aiming system, comprising:

a telescopic sight including a housing having a mounting surface that facilitates mounting the telescopic sight on a projectile weapon, the housing supporting an optical system of the telescopic sight and positioning the optical system relative to the mounting surface, the optical system forming at a focal plane an image of a field of view of the telescopic sight, the optical system including:

an objective having an optical axis,
terminal optics including a lens system positioned rearward of the objective and the focal plane, and
a light redirection device that receives light from the objective and redirects the light rearwardly along an optical path segment angled upwardly away from the optical axis,

the optical system defining an eye point spaced rearwardly from the terminal optics at which the image of the field of view is visible through the terminal optics, wherein the eye point is located on a line that is parallel to the optical axis of the objective but does not intersect the terminal optics; and

a second sight positioned in relation to the telescopic sight so that the line intersects the second sight, such that, when the telescopic sight is mounted to the projectile weapon via the mounting surface, a user can utilize both the telescopic sight and the second sight to aim the projectile weapon with a single eye and can switch between the telescopic sight and the second sight with essentially no head movement.

23. The projectile weapon aiming system of claim 22, wherein the light redirection device includes a prism positioned rearward of the lens system of the terminal optics.

24. The projectile weapon aiming system of claim 22, wherein the second sight is positioned within the housing.

25. The projectile weapon aiming system of claim 22, wherein the second sight is a non-magnifying reflex sight.

26. The projectile weapon aiming system of claim 22, wherein the optical system of the telescopic sight further includes an aiming reticle located at the focal plane.